

Countersunk head PLUSNUT® fastener - Unified Thread System

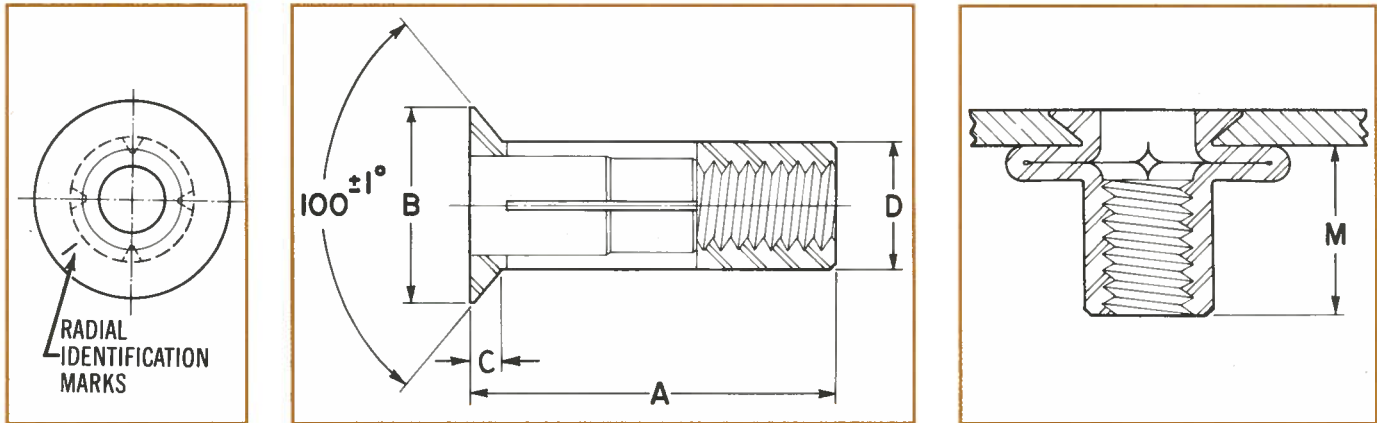

Materials and finishes

Material	Type No.	Standard Finish
STEEL	C-1010* C-1110*	Cadmium Plate — .0002" Minimum Thickness will meet MIL STD QQ-P-416, Class 3, Type I. Other finishes available.
STAINLESS STEEL	430	Passivated per MIL STD QQ-P-35, Type II
BRASS	Alloy No. 260	Bright as machined
ALUMINUM	6053-H16	Anodize per MIL-A-8625 Class I Type II

*C-1010 and C-1110 steel may be used interchangeably.

Specifications

Thread Size*	Type Number	Ident. Mark	Grip Range †		A ±.015	B Ref.	C Max.	D Max.	M Nom.	Inst. Drill Size	Inst. Hole Size		Wt. (Lbs./1000)		
			Min.	Max.							Min.	Max.	Alum.	Brass	Steel and Stainless
4-40	4P106	Blank	.051	.106	.500	.307	.051	.169	.250	11/64	.170	.175	.63	2.20	2.00
	4P151	1 Rad.	.106	.151	.562	.307	.051	.169	.250	11/64	.170	.175	.76	2.40	2.18
6-32	6P166	Blank	.065	.166	.672	.345	.063	.208	.340	#4	.209	.214	1.20	4.18	3.80
	6P271	1 Rad.	.166	.271	.781	.345	.063	.208	.340	#4	.209	.214	1.42	5.68	4.25
8-32	8P176	Blank	.065	.176	.672	.377	.063	.241	.335	C	.242	.247	1.54	5.17	4.70
	8P271	1 Rad.	.176	.271	.781	.377	.063	.241	.335	C	.242	.247	1.75	5.76	5.24
10-32	10P196	Blank	.065	.196	.781	.412	.065	.272	.415	I	.273	.278	2.27	7.48	6.80
	10P321	1 Rad.	.196	.321	.922	.412	.065	.272	.415	I	.273	.278	2.51	8.49	7.72
1/4-20	25P296	Blank	.089	.296	1.015	.545	.089	.346	.505	S	.347	.352	4.64	15.42	14.02
	25P501	1 Rad.	.296	.501	1.234	.545	.089	.346	.505	S	.347	.352	5.28	17.83	16.21
5/16-18	31P301	Blank	.102	.301	1.156	.667	.102	.437	.565	7/16	.438	.453	8.25	27.68	25.16
	31P501	1 Rad.	.301	.501	1.375	.667	.102	.437	.565	7/16	.438	.453	9.48	31.57	28.70
3/8-16	37P316	Blank	.125	.316	1.250	.795	.124	.514	.610	33/64	.515	.522	12.01	40.17	36.52
	37P501	1 Rad.	.316	.501	1.453	.795	.124	.514	.610	33/64	.515	.522	13.33	44.55	40.50

*Both UNC and UNF threads are available in No.10 and larger sizes.

CODE: Diameter and grip range as tabulated. First letter of type number indicates material: "A" for aluminum, "S" for steel, "SS" for stainless steel, "BR" for brass.

EXAMPLE: S25P296 - Steel, 1/4 - 20 Internal Thread, .089 - .296 Grip Range

†Additional Grip Ranges are available.